



TREVA HODGES, PH.D.

MAYOR

CITY OF CHARLESTOWN

304 MAIN CROSS STREET
CHARLESTOWN, IN 47111

OFFICE: 812-256-4322
MOBILE: 502-297-4390

E-MAIL: MAYOR@CITYOFCHARLESTOWN.COM

January 19, 2023

City of Charlestown Common Council
304 Main Cross Street
Charlestown, IN 47111

Re: Request for Appropriation of 2022 General Fund Savings

Dear Council Members:

The City of Charlestown is in a fortunate position to fulfill an item from our 2021 Parks Master Plan through the receipt of a \$150,000 grant from the Community Foundation of Southern Indiana for the construction of an accessible playground at Greenway Park. This playground will replace the outdated play equipment currently installed in the park near the restroom facility and concession stand. I have included a rendering of the playspace design. Notable features are the replacement of mulch with a solid play floor, ramps to access the equipment and a double slide so that caregivers can slide in tandem with children, and a sensory play hut.

Bluegrass Recreation has provided an internal grant to reduce the total cost of the project to \$300,000. The city is responsible for the \$150,000 difference after the application of the Community Foundation grant. In addition to the playspace, we need to install fencing and solar lighting for security. Initial estimates received on fencing place the cost in the range of \$21,000 to \$36,900 and lighting at \$20,000. I am requesting that the Council appropriate savings from our general fund from 2022 to cover these expenses and additional improvements at Greenway Park, specifically, stabilization of the creek bed beside the Doug Coyne Pavilion. The total amount requested of this appropriation is \$278,476.00.

This appropriation request will be advertised and placed on the agenda for the February 6th Council meeting. Please let me know if you'd like to schedule a meeting with me to discuss this request.

Sincerely,

Treva Hodges, Mayor

Greenway Park



Playground











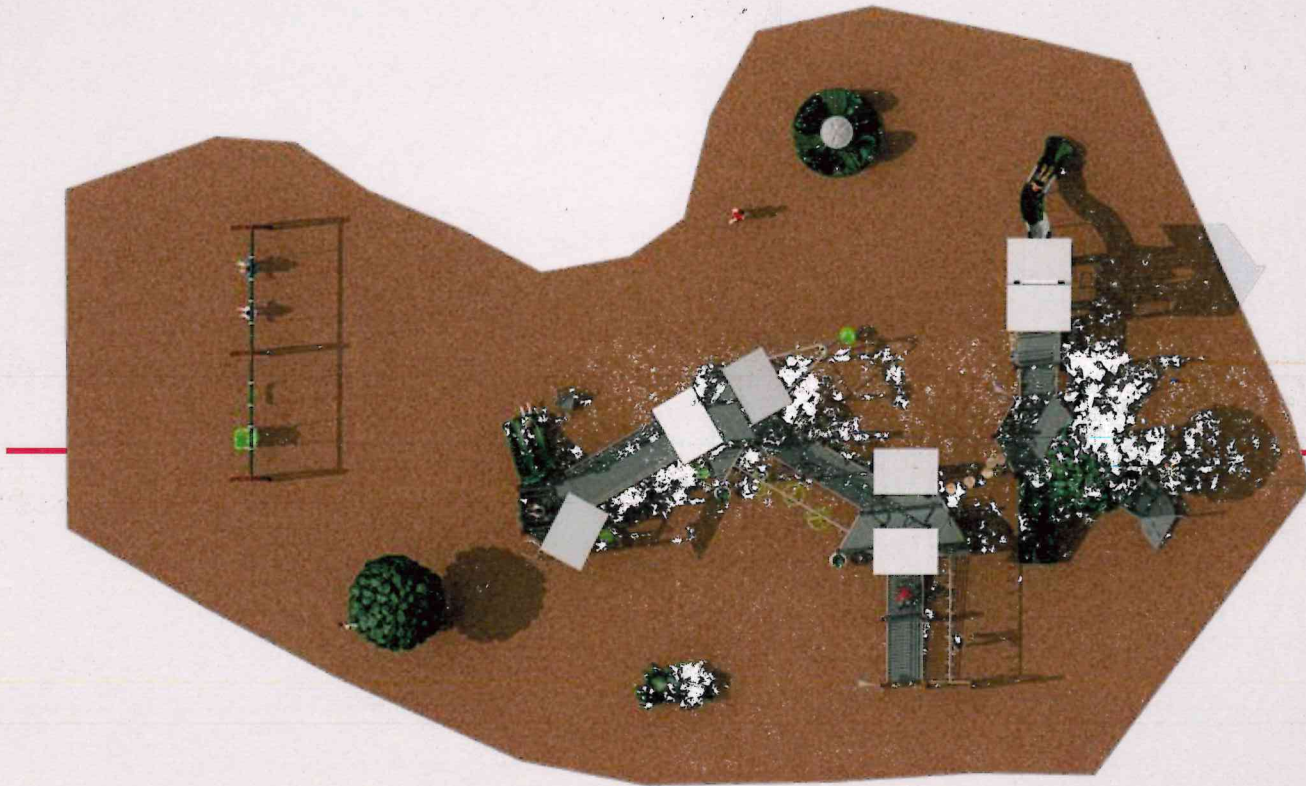

General Notes:

Age Group

2-5yrs 5-12yrs 2-12yrs 3+yrs

- The Americans with Disabilities Act (ADA) may require that you make your park and/or playground accessible when viewed in its entirety. Please consult your legal counsel to determine if the ADA applies to you.
- For playground equipment to be considered accessible, accessible surfacing must be utilized in applicable areas.
- Although a particular playground design may not meet the proposed Access Board Regulations in regards to the appropriate number of ground level events, the actual playground may be in compliance when considering existing play components.
- All deck heights are measured from top of ground cover.
- All abutting ground cover is required under and around all play equipment.
- The minimum recommended fall zone around the entire playstructure is shown. This zone is to be free of all tripping or collision hazards (i.e. roots, rocks, border material, etc.).
- All post lengths are identified by seat showing the post lengths. (i.e. 96" represents a 96" inch post).
- Just all equipment may be appropriate for all children. Supervision is required.

ADA COMPLIANT	2/2
BLINDING PLAY ACTIVITIES - TOTAL	0
ELEVATED PLAY ACTIVITIES ACCESSIBLE BY TRANSFER	0
ELEVATED PLAY ACTIVITIES ACCESSIBLE BY HAND	0
GROUND LEVEL ACTIVITY TYPE	0
GROUND LEVEL QUANTITY	0

ADA COMPLIANT	1/2
BLINDING PLAY ACTIVITIES - TOTAL	14
ELEVATED PLAY ACTIVITIES ACCESSIBLE BY TRANSFER	0
ELEVATED PLAY ACTIVITIES ACCESSIBLE BY HAND	0
GROUND LEVEL ACTIVITY TYPE	0
GROUND LEVEL QUANTITY	0

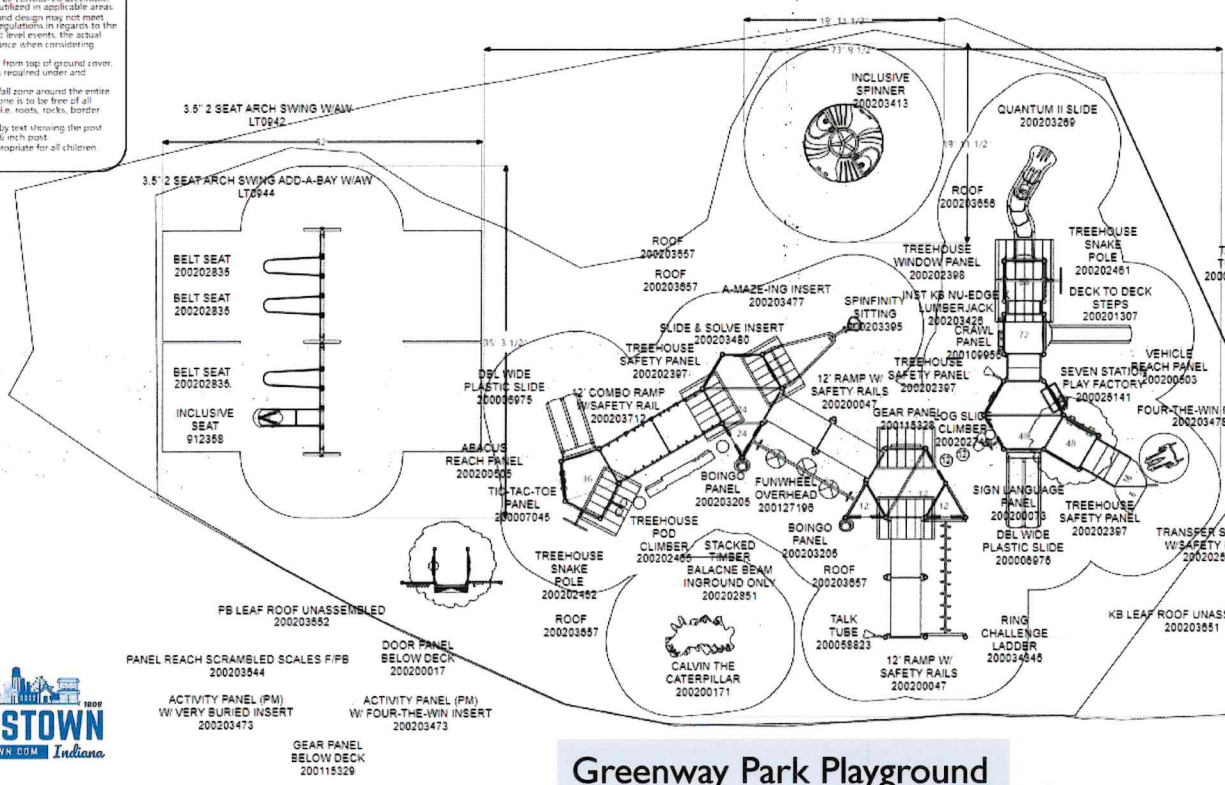

Greenway Park Playground

Project:
NuEdge Accessible Playground
Charlestown, IN

GC/PS rep:
Jennifer Birge
Bluegrass Recreation Sales and Installation
(502) 609-1996

Ground Space: 94'-6" x 53'-6"
Protective Area: 106'-6" x 67'-6"

Drawn by: Jennifer Birge
Date: 8/24/2022
DWG Name: R0335_44795625808

LTCPS - Farmington
878 East Highway 60
Monett, Missouri 65708
Voice: 1-800-325-8828
Fax: 417-354-2273

Playground Layout Compliance:

- ASTM F1487 - Playground Equipment for Public Use
- CPSC Handbook for Public Playground Safety
- This playground design meets the final Access Board Regulations.



The play components identified in this plan are LEED certified. The use and layout of these components conform to the requirements of ASTM F1487.

LEED points for this structure
1